

FLANGE DRILLING OPTIONS:-

BS4504 PN10 (DIN 2501)
4 HOLES 18 DIA
EQUI-SP ON 125 PCD OFFCENTRE

ANSI B16.5-150FF
4 HOLES 19 DIA
EQUI-SP ON 120.7 PCD OFFCENTRE

OPTIONS	INCLUDED		
AIR PURGE (2)	1/8"BSP	1/8"NPT	
FLANGE DRILLING	BS4504	ANSI	
GMU	kW		
APPROX VALVE WEIGHT			
CI+ST STL 35Kg : AL ALLOY 22Kg			
ORDER No.			
JOB No. J			
CERTIFIED			

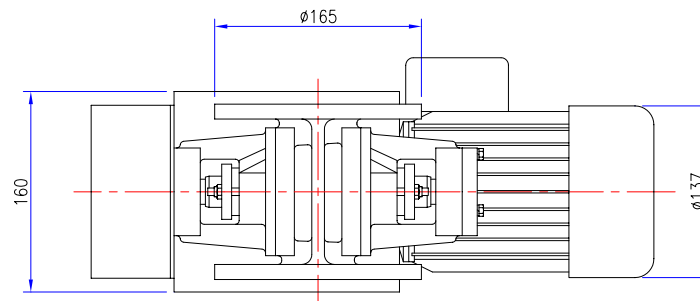
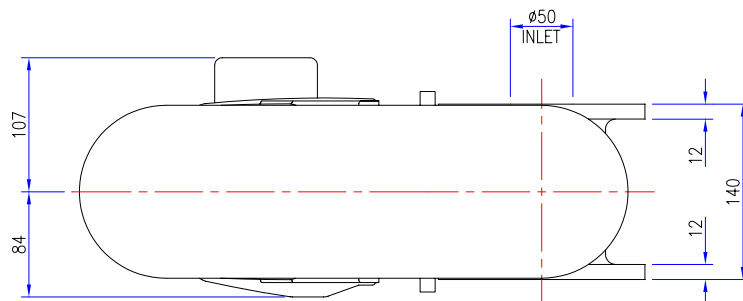
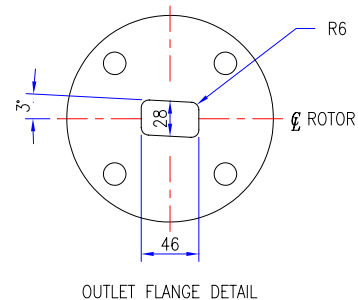
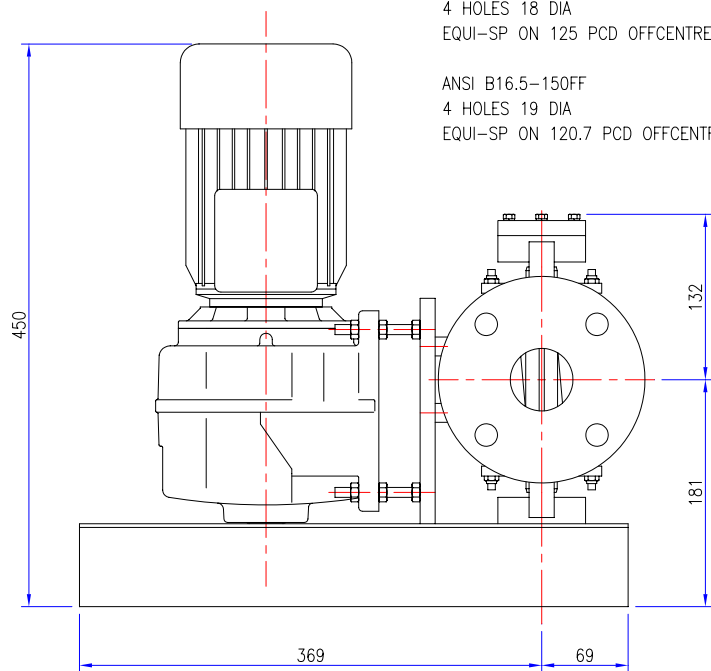

A	ORIGINAL
	REVISIONS

TOLERANCES	UP TO VALVE SIZE	VALVE SIZE & OVER
FACE-FACE	250 ±1.5	300 ±3
FLANGE THK.	450 ±3	500 ±5
PIPE O/D	100 ±1.5	115 ±2
OTHER	450 ±6	500 ±8

PROJECTION	
SCALE :	1:2 (A1)
DIMENSIONS IN mm	
©ROTA VAL	

ROTAVAL
CHIPPENHAM WILTS

DRN	CHKD	APPD	DATE
J.PORTER	SC	D.C.S	03-07-02

TITLE				ROUND FLANGE HD50 WITH DRIVE PLANNING IN DIMENSIONS	
JOB No.			DRG No.		SHEET/ISSUE
			RDF-HD50-WD		1 / A